

Quick Start Guide

Guía de Inicio Rápido /
Guide de démarrage rapide /
Schnellstartanleitung /
Guida d'avvio rapido

TRIPP LITE
SERIES

MPTL Cat6a STP Toolless RJ45 Plug, PoE++ Compliant

N238-P01-MPTL-A

**Clavija RJ45 sin herramientas STP
MPTL Cat6a, compatible con PoE++
Fiche RJ45 STP MPTL Cat6a sans outil,
conforme à PoE++**

**MPTL Cat6a STP Toolless RJ45 Plug,
PoE++ Compliant**

**Connettore RJ45 toolless STP Cat6a
MPTL, conforme a PoE++**

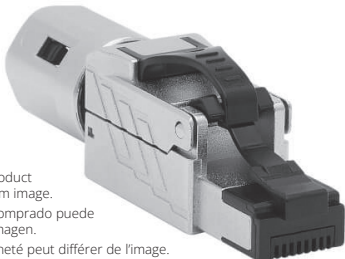

Purchased product
may differ from image.

El producto comprado puede
diferir de la imagen.

Le produit acheté peut différer de l'image.

Das gekaufte Produkt kann vom Bild abweichen.

Il prodotto acquistato potrebbe differire
dall'immagine.

EATON

Powering Business Worldwide

Installation

Instalación / Installation /
Installation / Installazione

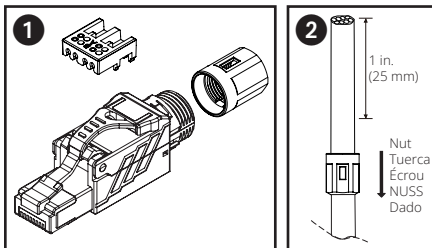

- 3** Organize the braided / drain wire / foil to approximately 0.5 in. (10~12 mm).
Organice el cable trenzado / de drenaje / pantalla a aproximadamente 10~12 mm [0.5"]
Organisez le fil / la feuille tressée / de drainage à environ 10~12 mm (0,5 po).
Organisieren Sie das geflochtene / Ableitungs-Kabel / Folie auf ungefähr 0,5 Zoll (10 ~ 12 mm).
Organizzare la treccia/il conduttore di terra/la lamina a circa 0,5 in. (10~12 mm).

Installation

Instalación / Installation / Installation / Installazione

- A** Leave approximately 0.25 in. (6~8 mm) excess foil for A/B wires (orange / green pairs).
Deje aproximadamente 0.25 pulgadas (6 ~ 8 mm) de lámina excedente para los cables A/B (pares naranja/verde).
Laissez un excédent de feuille d'environ 6 à 8 mm (0,25 po) pour les fils A/B (paires orange / verte).
Lassen Sie für A/B-Leitungen (orange/grüne Paare) ungefähr 0,25 Zoll (6 ~ 8 mm) überschüssige Folie.
Lasciare circa 0,25 in. (6~8 mm) di lamina in più per i fili A/B (coppie arancione/verde).
- B** 1 in. (25 mm)
- C** 0.5 in. (10~12 mm)
- D** 0.25 in. (6~8 mm)

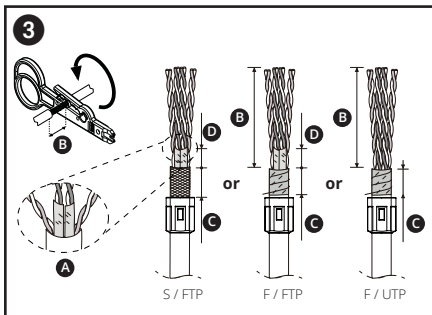

Installation

Instalación / Installation / Installation / Installazione

- 4 Follow the wire scheme map and angle to route A/B wires through the IDC cap.
- Siga el mapa y ángulo del esquema de cableado para conducir los cables A/B a través del tapón de IDC.
- Suivez le schéma de câblage et l'angle pour acheminer les fils A/B à travers le capuchon de l'IDC.
- Befolgen Sie die Kabelschema-Karte und den Winkel, um die A/B-Kabel durch die IDC-Kappe zu führen.
- Seguire lo schema dei fili e piegare ad angolo per instradare i fili A/B attraverso il cappuccio IDC.

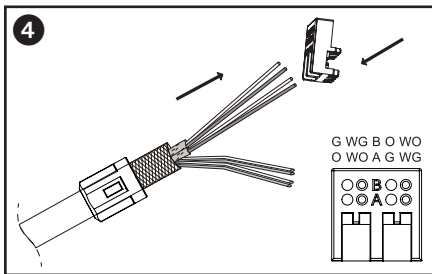

Installation

Instalación / Installation /
Installation / Installazione

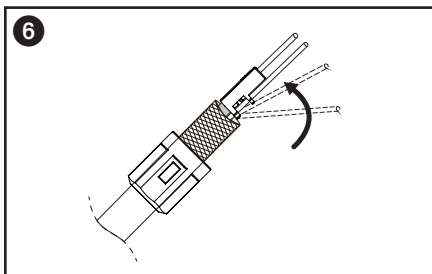
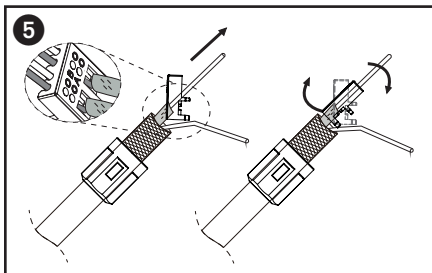

Installation

Instalación / Installation / Installation / Installazione

- 7/8** Use a pair of wire cutters to make the front row wires flush.
- Use un par de cortadores de cables para que el frente de la fila de cables esté al ras.
- Utilisez une paire de coupe-fils pour aligner les fils de la rangée avant à ras.
- Verwenden Sie eine Drahtschere um die Drähte der vorderen Reihe bündig zu machen.
- Utilizzare un tronchese per portare a filo i fili della fila anteriore.

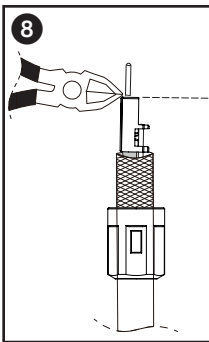
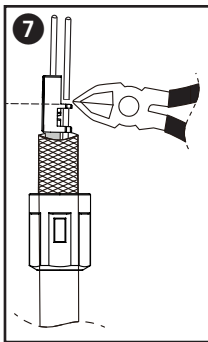

Installation

Instalación / Installation /
Installation / Installazione

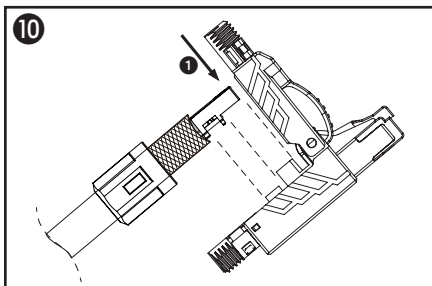
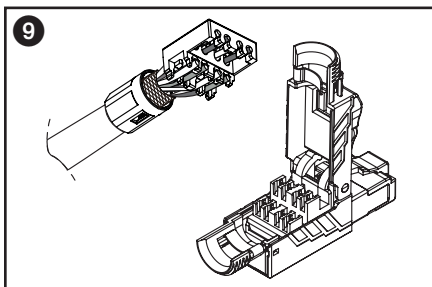

Installation

Instalación / Installation /
Installation / Installazione

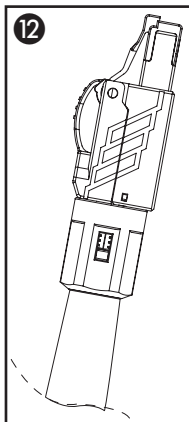
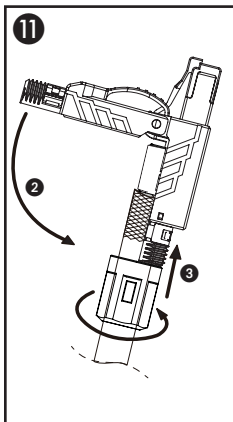

EATON
Powering Business Worldwide

Eaton
1000 Eaton Boulevard
Cleveland, OH 44122
United States
Eaton.com

© 2024 Eaton
All Rights Reserved
Publication No.
24-07-094 /
93-4B85_RevA
December 2024

Eaton has a policy of continuous improvement. Specifications are subject to change without notice.

Eaton is a registered trademark.

All trademarks are property of their respective owners.